

Quick Start Guide

Poooli L3

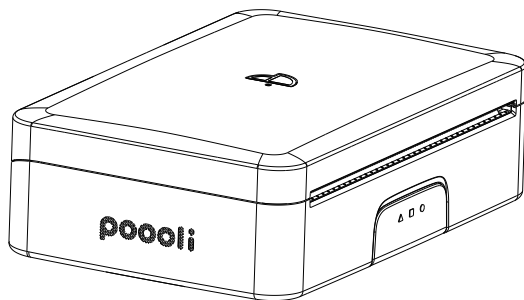

FCC

This device complies with part 15 of the FCC Rules. Operation is subject to the following two conditions: (1) this device may not cause harmful interference, and (2) this device must accept any interference received, including interference that may cause undesired operation.

Any changes or modifications not expressly approved by the party responsible for compliance could void the user's authority to operate the equipment.

NOTE: This equipment has been tested and found to comply with the limits for a Class B digital device, pursuant to Part 15 of the FCC Rules. These limits are designed to provide reasonable protection against harmful interference in a residential installation. This equipment generates, uses and can radiate radio frequency energy and, if not installed and used in accordance with the instructions, may cause harmful interference to radio communications.

However, there is no guarantee that interference will not occur in a particular installation. If this equipment does cause harmful interference to radio or television reception, which can be determined by turning the equipment off and on, the user is encouraged to try to correct the interference by one or more of the following measures:

- Reorient or relocate the receiving antenna.
- Increase the separation between the equipment and receiver.
- Connect the equipment into an outlet on a circuit different from that to which the receiver is connected.
- Consult the dealer or an experienced radio/TV technician for help.

To maintain compliance with FCC's RF Exposure guidelines, This equipment should be installed and operated with minimum distance between 20cm the radiator your body: Use only the supplied antenna.

Packing List



Poooli L3



Quick Start Guide



Thermal Paper Roll

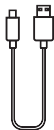

USB Cable

⚠ Note: The packing items are actually based on the order.

Appearance and Components

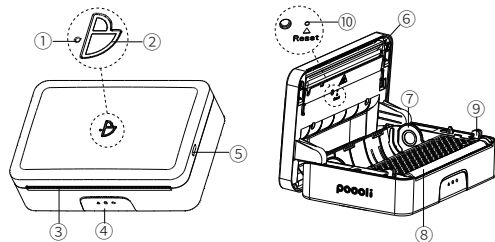

LED Indicator

Power Button

Paper Outlet

Cover Opening Button

TYPE-C Charging Port

TPH

Paper Guide

Platen

Fastener for Top Cover

Reset Button

Using Guide



LED Indicator Status

- Green LED is lighting: power on/standby/fully charged/printing
- Green LED is slowly flashing: receiving gray-scale data
- Green Notify LED is slowly flashing: charging/firmware updating
- Red LED is lighting: cover opened/out of paper
- Red LED is quickly flashing: low-power status (quick flash twice, slow flash once)/TPH over temperature
- Red LED is slowly flashing: label positioning failure



Charging

Use it for the first time after purchase

- Recommended to use after full charge
- For computer USB port charging only



USB Cable

In addition to the supplied USB cable, you can also use the charging cable of mobile device

- Recommended to use the supplied USB charging cable to charge
- It takes about 3.5 hours to charge with 2A

Connection

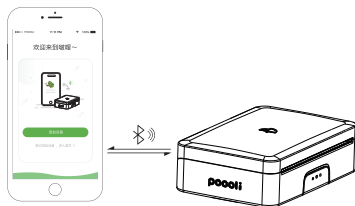

Register and log in to the app, click Add Device. Connect to the device by searching for Bluetooth or scanning code.

APP Setting



Bluetooth 4.0

Bluetooth pairing

- If the first connection succeeds, the next time you start the application, it will be automatically connected to Poooli.



Simple operation

APP setting

- You can view information such as remaining power, firmware version in device management.

Replace Supplies

1. Place the printer on the flat surface.



⚠ Please be careful about your fingers when holding the printer.

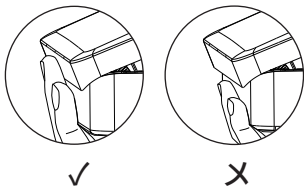

2. Press the cover opening button, and the top cover will be opened automatically.

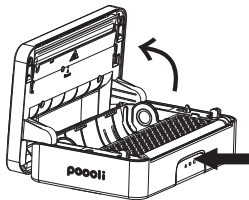

⚠ When changing supplies, do not touch the print head in case of injury caused by overheating.

3. Insert two paper guides into the corresponding place (57.8/80/110) according to the paper width, and then place the paper roll.

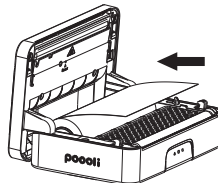
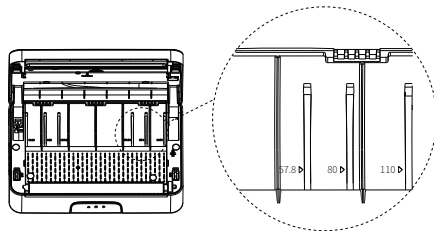

Note:
Insert the paper guides into the slot of each value and make them fixed, then place the paper roll.

1) 2-inch width: insert two paper guides into the place of 57.8 as the figure shown below:

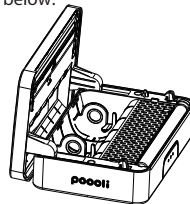

2) 3-inch width: insert two paper guides into the place of 80 as the figure shown below:

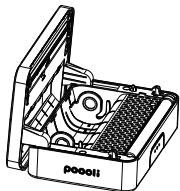

3) 4-inch width: insert two paper guides into the place of 110 as the figure shown below:

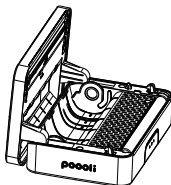

4. Pull the end of the paper roll towards the paper outlet, then close the cover.

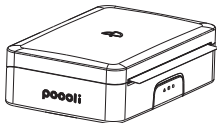

Safety Precautions



Battery Overheating

Battery Management and Precautions

- When charging is completed, please unplug the USB cable.
- To avoid fire, do not charge at high temperature (e.g. sweating rooms, bonfire nearby, etc.).



Charger Attention

Print Head Management and Precautions

- There may be damage to the print head due to improper charging.
- We recommend not to use Pooli in high humidity or dusty areas.



Burn Hazard

Print Head Overheating

- After printing, do not touch the print head directly in case of injury caused by overheating.



Charging Port Damage

Charging Precautions

- Please gently insert or unplug the USB cable to prevent excessive damage to the charging port.